

2000-

4RUNNER

TVIP V5

RS3200 PLUS
OWNER'S GUIDE



RS3200 PLUS

SECURITY SYSTEM
DESIGNED FOR USE WITH YOUR VEHICLE'S
REMOTE KEYLESS ENTRY SYSTEM

OWNER'S GUIDE

To better understand the features and functions of this security system, please read this Owner's Guide completely prior to use.

TABLE OF CONTENTS

| DESCRIPTION | PAGE |
|--|------|
| INTRODUCTION | 2 |
| BRIEF DESCRIPTION—RS3200 Plus FEATURES | 3, 4 |
| OPERATION | |
| ARMING THE RS3200 PLUS (except PASSIVE ARMING) | 5 |
| DISARMING THE RS3200 PLUS (except PASSIVE DISARMING) | 6 |
| PASSIVE (AUTOMATIC) ARMING & DISARMING | 7 |
| AUTOMATIC REARMING | 8 |
| ARMING SUSPENSION | 8 |
| MISCELLANEOUS | |
| IGNITION CONTROLLED DOOR LOCK/UNLOCK (4RUNNER ONLY) | 9 |
| ALARM INFORMATION | |
| ALARM TRIGGERS | 10 |
| ALARM DESCRIPTIONS | 11 |
| STOPPING AN ALARM | 11 |
| GLASS BREAKAGE SENSOR INFORMATION | |
| GLASS BREAKAGE SENSOR CHECK PROCEDURE | 12 |
| PROGRAMMING | |
| PASSIVE (AUTOMATIC) ARMING AND ENTRY DELAY | 13 |
| IGNITION CONTROLLED DOOR LOCK/UNLOCK (4RUNNER ONLY) | 14 |
| WARNING and CAUTION INFORMATION | 15 |

INTRODUCTION

Congratulations on your choice of the RS3200 PLUS add-on security system to protect your vehicle! To get the most from the system, we strongly recommend that you read this Owner's Guide completely to learn all of its features and functions.

The RS3200 PLUS provides security through point-of-entry monitoring, glass breakage detection and ignition switch monitoring. While ARMED, the system will be TRIGGERED and sound an ALARM when a door, trunk or hatch is forcibly unlocked or opened*, or when a window is tapped on or broken. During the ALARM, the vehicle's horn sounds and the headlights, tail lights and front marker lights flash. Also, the vehicle's starter is disabled, preventing engine start. In addition to the comprehensive protection, the RS3200 PLUS works in conjunction with your vehicle's remote keyless entry system, enabling you to ARM and DISARM the security system at the same time the doors are remotely locked and unlocked. In vehicles equipped with a buzzer, it will chirp when the system is REMOTE ARMED and DISARMED.

An important note about your system

Throughout this guide, there are references to the STATUS MONITOR^① for this system. Illustrated below, this panel holds the LED indicator (for the system's operating status) and the GLASS BREAKAGE SENSOR's microphone. In vehicles equipped with an engine immobiliser system, there is a LED already installed, so the RS3200 PLUS utilizes the vehicle's engine immobiliser system LED^② instead and a microphone mounted in a separate location. If your vehicle falls into this category, remember to look at that LED when the information refers to the STATUS MONITOR. If you do not know where the LED is located, refer to your vehicle's owner's guide for specific information.

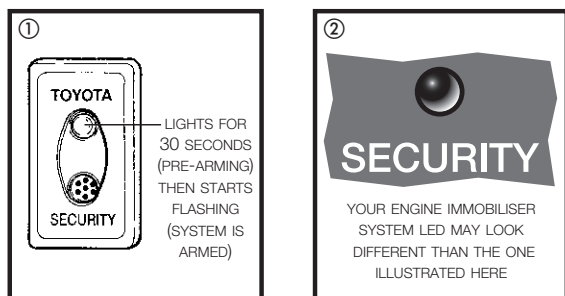

About the ignition-controlled automatic door locking/unlocking function (4RUNNER ONLY)

The RS3200 PLUS is programmed to automatically lock your vehicle's doors when you turn the key in the ignition switch to the "ON" or "START" position, and unlock them when you turn the key back to the "ACC" or "LOCK" position. You may disable this feature by reprogramming the system; refer to page 14 for programming information.

* When the system is PASSIVELY (AUTOMATICALLY) ARMED, there is an ENTRY DELAY that will elapse when a door is opened before an ALARM is TRIGGERED.

BRIEF DESCRIPTION-RS3200 Plus FEATURES

| FEATURES | FUNCTIONS |
|----------------------------|--|
| REMOTE ARMING/DISARMING | The RS3200 PLUS will ARM 30 seconds after the lock button on the remote keyless entry system's remote control is pressed, and DISARM when the unlock button is pressed. If your vehicle is equipped with a buzzer that chirps when the lock and unlock buttons on the remote controls are pressed, the buzzer will also chirp when the system is REMOTE ARMED and DISARMED. |
| AUTOMATIC REARMING | The RS3200 PLUS will automatically REARM at the same time the vehicle's remote keyless entry system relocks the vehicle's doors, if no door is opened within 30 seconds after REMOTE DISARMING. |
| KEY ARMING/DISARMING | The RS3200 PLUS will ARM 30 seconds after you close the trunk (if open) and lock the vehicle's doors with the key, and will DISARM when you unlock a door with the key. |
| ARMED MODE SUSPENSION | While ARMED, the trunk may be opened with the key (or trunk release button on your remote control, if so equipped) without TRIGGERING an ALARM. Once the open trunk is closed, the system ARMS again. |
| PASSIVE (AUTOMATIC) ARMING | The RS3200 PLUS may be programmed to automatically ARM 30 seconds after the ignition key is removed, the vehicle exited and the last door and the trunk closed, without the necessity of locking doors. |
| PASSIVE DISARMING | The RS3200 PLUS may be DISARMED with the vehicle's ignition key after it was PASSIVELY ARMED. |
| ADJUSTABLE ENTRY DELAY | When the RS3200 PLUS has been PASSIVELY ARMED, an ENTRY DELAY (user-selectable at 0, 15, or 30 seconds) will start when a door is opened before an ALARM is TRIGGERED. |
| MANUAL ARMING | When you lock the vehicle with the central lock switch (while a door is open), the RS3200 PLUS will ARM 30 seconds after you close all the doors and the trunk (if open). |
| IGNITION KEY DISARMING | The RS3200 PLUS may be DISARMED by inserting the key into the ignition switch and turning it to "ON." |
| POINT-OF-ENTRY PROTECTION | Forcibly unlocking or opening a door or trunk while the RS3200 PLUS is ARMED will TRIGGER an ALARM immediately. <i>(If the system was PASSIVELY ARMED, the ENTRY DELAY must pass after opening a door before the ALARM is TRIGGERED.)</i> |
| GLASS BREAKAGE SENSOR | The RS3200 PLUS utilizes a microphone (usually mounted in the STATUS MONITOR) to sense the noise from tapping on window glass, or glass breaking, and TRIGGER the system to sound an ALARM. It is fine tuned to "listen" for this type of noise, and ignore other sounds. |
| WARN AWAY ALARM | When the GLASS BREAKAGE SENSOR's microphone picks up tapping or breaking of window glass, it TRIGGERS a WARN AWAY ALARM; the headlights and tail and marker lights flash, and the horn sounds for 20 seconds, but the starter is not disabled. If there is another detection of glass tapping or breaking, or if a door is opened or unlocked without a key, the regular ALARM is TRIGGERED. |
| IGNITION SWITCH MONITORING | While ARMED, the RS3200 PLUS monitors the ignition switch. If an attempt is made to start the vehicle without a key, an ALARM is TRIGGERED. |

BRIEF DESCRIPTION—RS3200 PLUS FEATURES

| FEATURES | FUNCTIONS |
|--|---|
| STARTER DISABLE | When an ALARM is TRIGGERED, the system disables the vehicle's starter and prevents engine start until the system is reset (DISARMED). |
| FORCED LOCK DURING ALARM | During an ALARM, the system will lock the doors if one is unlocked, and will continue to do so for the duration of the ALARM. |
| TRIGGER MEMORY | The user is notified that an ALARM occurred. Upon DISARMING the system after an ALARM was TRIGGERED, the vehicle's tail and marker lights will be turned on for 2 seconds. |
| EXTERIOR LIGHT ACTIVATION | The RS3200 PLUS flashes the vehicle's tail and marker lights during REMOTE ARMING and REMOTE DISARMING, and during an ALARM. Also, during an ALARM the headlights flash. |
| BUZZER ACTIVATION | If your vehicle is equipped with a buzzer that chirps when the lock and unlock buttons on the remote keyless entry system's remote controls are pressed, the buzzer will also chirp when the system is REMOTE ARMED and DISARMED. |
| HORN ACTIVATION | During an ALARM, the RS3200 PLUS activates the vehicle's horn. |
| POWER LOSS MEMORY | If power to the RS3200 PLUS is disrupted while it is ARMED, an ALARM is TRIGGERED once power is restored. |
| STATUS MONITOR | This panel houses the GLASS BREAKAGE SENSOR microphone and the flashing LED that indicates the operating status of the security system. (Some vehicle applications utilize the vehicle's engine immobiliser system LED and a separate microphone, instead.) |
| IGNITION-CONTROLLED AUTOMATIC DOOR LOCK/UNLOCK | The RS3200 PLUS automatically locks your vehicle's doors when you turn the ignition key to "ON" or "START", and unlocks the doors when you turn the key back to "ACC" or "LOCK".* |

* This feature available *ONLY IN 4RUNNER*. You may disable this feature. Please refer to page 14 for programming information.

OPERATION

ARMING THE RS3200 Plus (except PASSIVE ARMING)

The system may be ARMED in several ways. Do *one* of the following:

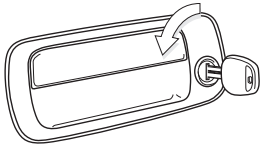

TURN TOWARD THE FRONT
OF THE VEHICLE

Lock the doors with your key:

Remove the key from the ignition switch.
Exit the vehicle, and close all the doors.*
Close the trunk or hatch, if necessary.*
Insert the key into the door key switch and turn it toward the front of the vehicle:

The STATUS MONITOR'S LED turns on for 30 seconds, then starts flashing.^① The system is now ARMED.

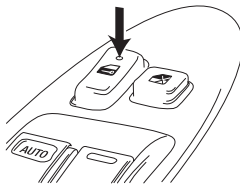

PUSH THE LOCK SWITCH WHILE
THE DOOR IS OPEN

Lock the doors from inside the vehicle:

Remove the key from the ignition switch.
Open the driver's or front passenger's door.
Push the central lock switch.
Exit the vehicle, and close all the doors.*
Close the trunk or hatch, if necessary.* Then:

The STATUS MONITOR'S LED turns on for 30 seconds, then starts flashing.^① The system is now ARMED.

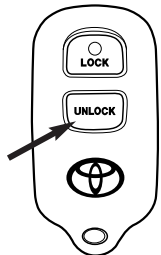

PRESS AND RELEASE
THE LOCK BUTTON

Lock the doors with the remote control:

Remove the key from the ignition switch.
Exit the vehicle, and close all the doors.*
Close the trunk or hatch, if necessary.*
Press the lock button on the remote control. Simultaneously:

The doors lock.^②

The vehicle's tail and marker lights flash once.^③

The vehicle's buzzer chirps once.^Δ

The STATUS MONITOR'S LED turns on for 30 seconds, then starts flashing.^① The system is now ARMED.

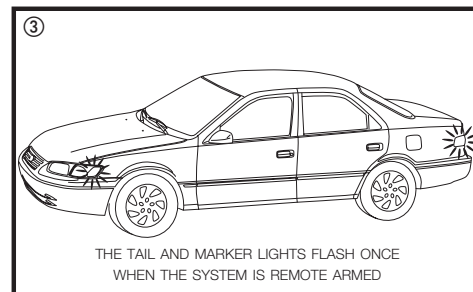
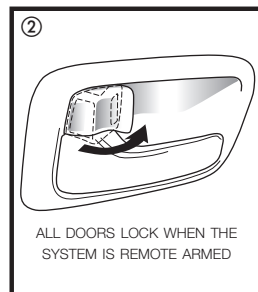
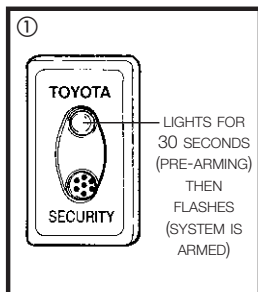

* The system will not ARM while any of the doors, trunk or hatch is open.

Δ If your vehicle is equipped with a buzzer.

OPERATION

DISARMING THE RS3200 Plus (except PASSIVE DISARMING)

The system may be DISARMED in several ways. Do *one* of the following:

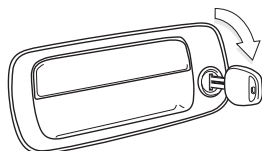

TURN TOWARD THE REAR
OF THE VEHICLE

Unlock the doors with your key:

Insert the key into the door key switch and turn it toward the rear of the vehicle:

The STATUS MONITOR'S LED stops flashing.^① The system is now DISARMED.*

In the case of Sienna and 4Runner, you may also disarm the system using the key in the back door; all doors will unlock at the same time.

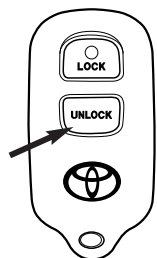

PUSH THE UNLOCK BUTTON

Unlock the doors with the remote control:

Press the unlock button on the remote control. Simultaneously:

The driver's door unlocks.^②

The vehicle's tail and marker lights flash twice.^③

The vehicle's buzzer chirps twice.^Δ

The STATUS MONITOR'S LED stops flashing.^① The system is now DISARMED.*

Press the unlock button again within 3 seconds after unlocking the driver's door to unlock the remaining doors.

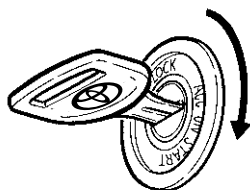

TURN THE KEY TO "ON" TO
DISARM THE SYSTEM

Use the ignition switch:

Insert the key into the ignition switch, then turn it to ON.

The STATUS MONITOR'S LED stops flashing.^① The system is now DISARMED.*

This method of disarming is rarely used. You must be inside the vehicle while the system is armed in order to do it.

NOTE: If your vehicle's tail and marker lights turn on for 2 seconds when the system is DISARMED,* the TRIGGER MEMORY was activated; something TRIGGERED an ALARM while you were away from the vehicle.

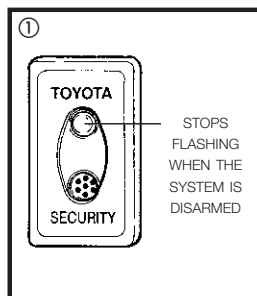

STOPS
FLASHING
WHEN THE
SYSTEM IS
DISARMED

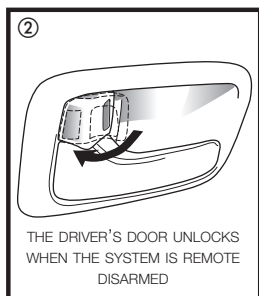

THE DRIVER'S DOOR UNLOCKS
WHEN THE SYSTEM IS REMOTE
DISARMED

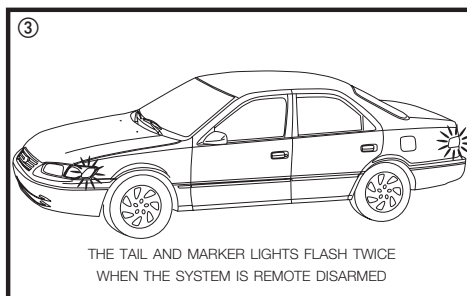

THE TAIL AND MARKER LIGHTS FLASH TWICE
WHEN THE SYSTEM IS REMOTE DISARMED

* Please note, if the system utilizes your vehicle's engine immobiliser system LED instead of the STATUS MONITOR, the LED will continue to flash.

Δ If your vehicle is equipped with a buzzer.

OPERATION

PASSIVE (AUTOMATIC) ARMING & DISARMING

When the RS3200 PLUS is programmed to PASSIVELY ARM, the system will ARM after the ignition key is removed and all doors and the trunk are closed; you do not need to lock the doors. When you come back to your vehicle and open a door, you must insert the key into the ignition switch and turn it to "ON" during the ENTRY DELAY (0, 15 or 30 seconds), or an ALARM will be TRIGGERED. If you lock the doors, regular ARMING will override PASSIVE ARMING; there will be no ENTRY DELAY. See the PROGRAMMING information on page 13 to activate the PASSIVE ARMING mode, as well as to select the ENTRY DELAY time.

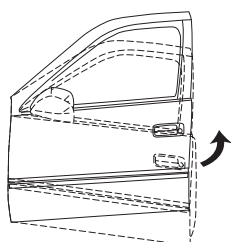

THE SYSTEM ARMS 30 SECONDS
AFTER THE LAST ENTRY POINT
(DOOR, TRUNK OR HATCH)
IS CLOSED

To PASSIVELY ARM the system:

Remove the key from the ignition switch.

Exit the vehicle, and close all the doors. *(The system will not ARM while any of the doors are open.)*

Close the trunk or hatch, if necessary. *(The system will not ARM while the trunk or hatch is open.)*

After the last door, trunk or hatch is closed:

The STATUS MONITOR'S LED turns on for 30 seconds, then starts flashing.^① The system is now ARMED.

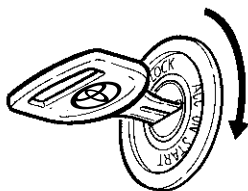

THE SYSTEM DISARMS WHEN
YOU INSERT THE KEY AND TURN IT
TO "ON"

To DISARM the PASSIVELY ARMED system:

Enter the vehicle through a front door.

The ENTRY DELAY begins:

The STATUS MONITOR'S LED turns on (no flashing.)^②

Insert the key into the ignition switch and turn it to "ON" before the ENTRY DELAY ends.*

The LED turns off. The system is now DISARMED.

You may also DISARM the system following any of the methods described on page 6.

NOTE: If your vehicle's tail and marker lights turn on for 2 seconds when the ignition key is turned to "ON", the TRIGGER MEMORY was activated; something TRIGGERED an ALARM while you were away from the vehicle.

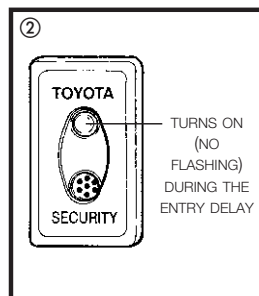
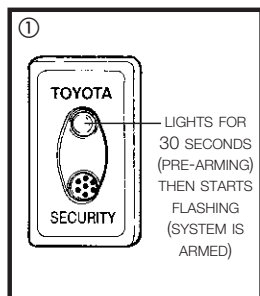

* If the ENTRY DELAY time elapses before the ignition switch is turned to "ON", an ALARM will be TRIGGERED. To DISARM the system during an ALARM, insert the ignition key and turn it to "ON", or press and release the remote control's unlock button.

OPERATION

AUTOMATIC REARMING

When you unlock the doors using the remote control, the RS3200 PLUS is DISARMED at the same time. However, if you do not open a door or the trunk within 30 seconds, the keyless entry system will relock the doors and the RS3200 PLUS will REARM 30 seconds later.

How the RS3200 PLUS automatically REARMS:



THE DOORS ARE UNLOCKED BY PRESSING THE UNLOCK BUTTON ON THE REMOTE CONTROL...

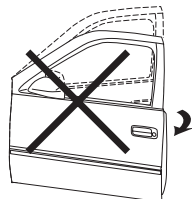

WHEN NO DOOR, TRUNK OR HATCH IS OPENED...

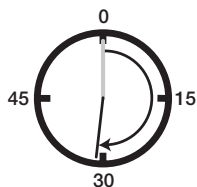

FOR MORE THAN 30 SECONDS...

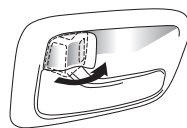

THE KEYLESS ENTRY SYSTEM AUTOMATICALLY RELOCKS THE DOORS, THEN THE RS3200 PLUS AUTOMATICALLY REARMS.



THE LED WILL LIGHT UP FOR 30 SECONDS (PRE-ARM), THEN FLASH WHEN THE SYSTEM IS ARMED

ARMING SUSPENSION

The ARMED state of the RS3200 PLUS can be suspended temporarily by using the key to unlock and open the trunk. If your remote control is so equipped, you may also suspend the ARMED state using the trunk release button^① to open the trunk. When the ARMING is suspended, the STATUS MONITOR'S LED will turn off^② until the trunk is closed again.

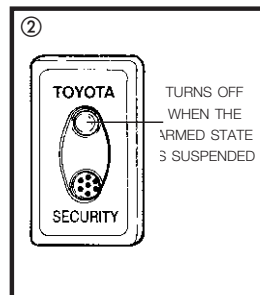
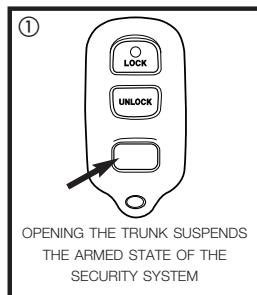

MISCELLANEOUS

IGNITION-CONTROLLED DOOR LOCKING/UNLOCKING (4RUNNER ONLY)

The RS3200 Plus is programmed to automatically lock your vehicle's doors when you turn the ignition key to "ON" or "START", and unlock the doors when you turn the key back to "ACC" or "LOCK". If you start the vehicle while a door is open, the system will not lock the doors; you must lock them manually.

How the RS3200 Plus automatically locks and unlocks the doors:

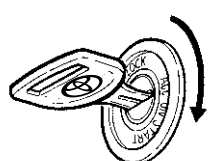

WITH ALL THE DOORS
CLOSED, TURN THE KEY TO
THE "ON" OR "LOCK"
POSITION...

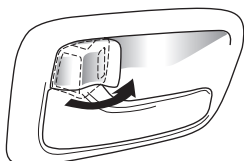

ALL THE DOORS ARE
LOCKED AUTOMATICALLY.

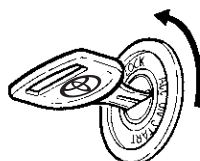

WHEN THE KEY IS TURNED
BACK TO THE "ACC" OR
"LOCK" POSITION...

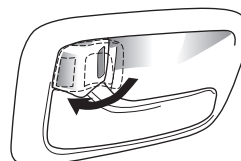

ALL THE DOORS ARE
UNLOCKED.

This feature may be defeated by changing the system's programming. Refer to page 14 for programming instructions.

ALARM INFORMATION

ALARM TRIGGERS

While the system is ARMED, an ALARM will be TRIGGERED when any of the following occurs:

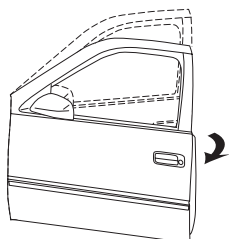

- ➔ **Forcibly opening a door, or the trunk or hatch without a key**

Pulling the trunk release lever inside the vehicle will also TRIGGER an ALARM.

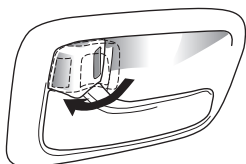

- ➔ **Manually unlocking a door**

Manually operating an inside lock button will TRIGGER an ALARM.

Note: Because this action will TRIGGER an ALARM, it is important that you do not ARM the system while someone is in the vehicle.

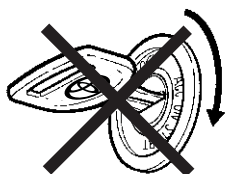

- ➔ **"Hot wiring" the vehicle**

The RS3200 PLUS can detect the absence of the ignition key if the ignition circuit is shorted in attempt to start the vehicle.

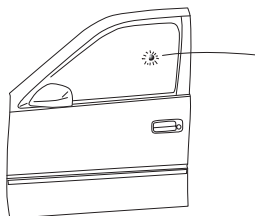

- ➔ **Tapping on or breaking the glass**

The noise from tapping on, or breaking of glass TRIGGERS a WARN Away ALARM first, then a regular ALARM. See the description of how the GLASS BREAKAGE SENSOR TRIGGERS ALARMS on page 12.

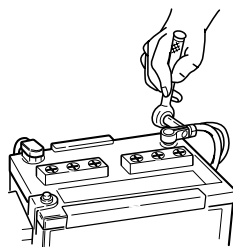

- ➔ **Power restoration**

If power to the system is interrupted while it is ARMED, an ALARM will be TRIGGERED immediately when power is restored.

ALARM INFORMATION

ALARM DESCRIPTIONS

Regular ALARM^①

When an ALARM is triggered in any way other than initial detection by the GLASS BREAKAGE SENSOR, the following occur:

- The horn sounds repeatedly for 60 seconds.
- The headlights flash repeatedly for 60 seconds.
- The tail and marker lights flash repeatedly for 60 seconds.
- The starter is disabled (no engine start) until the system is DISARMED.
- The door lock will be relocked if someone reaches in and unlocks the inside lock button.

After 60 seconds of ALARM, the system will REARM and continue to protect the vehicle.

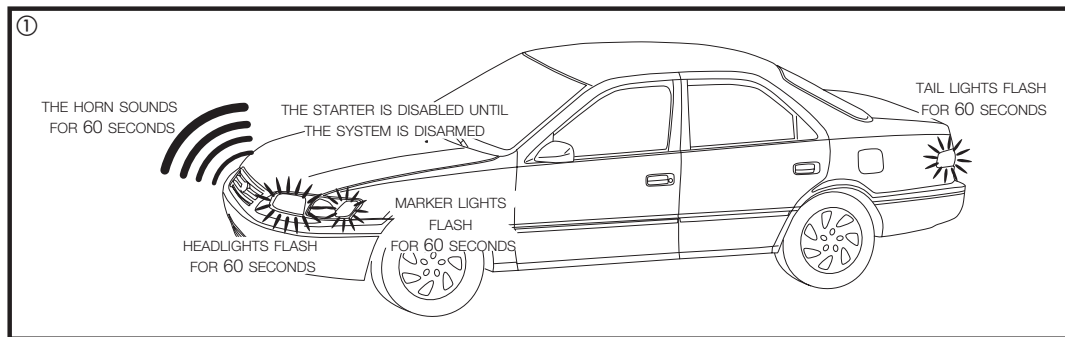

WARN-Away ALARM^②

Upon initial detection of noise from tapping on, or breaking glass, the GLASS BREAKAGE SENSOR TRIGGERS a WARN Away ALARM:

- The horn sounds repeatedly for 20 seconds.
- The headlights flash repeatedly for 20 seconds.
- The tail and marker lights flash repeatedly for 20 seconds.

If the GLASS BREAKAGE SENSOR detects noise again, or if a door or trunk is opened while the system is still ARMED, the regular ALARM (described above) is activated.

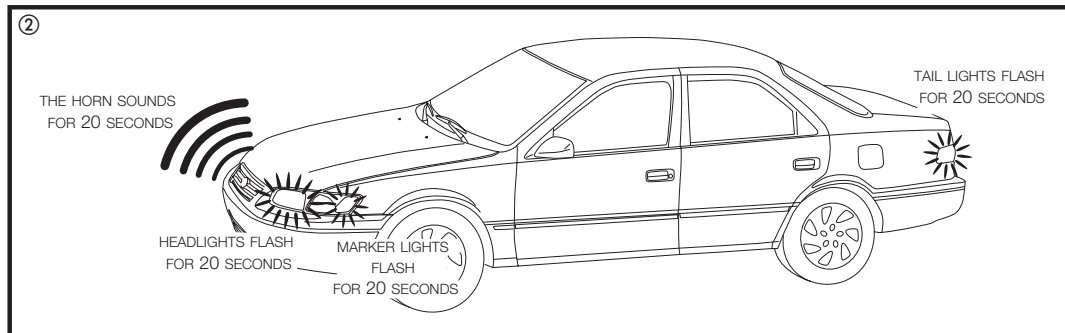

STOPPING AN ALARM

Simply DISARM the system using the remote control or key as described on page 6.

GLASS BREAKAGE SENSOR INFORMATION

The RS3200 PLUS provides protection for your vehicle above and beyond entry point monitoring—it “listens” for the noise made by tapping on, or breaking of glass. Using a microphone designed specifically for this task, the GLASS BREAKAGE SENSOR is capable of ignoring other noises, which helps to prevent “false alarms” from occurring.

GLASS BREAKAGE SENSOR CHECK PROCEDURE

When the RS3200 PLUS was installed in your vehicle, care was taken to adjust the sensitivity level of the GLASS BREAKAGE SENSOR. You may observe how it works following the procedure listed below.

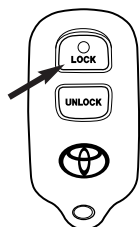

1. ARM the system.

Press the lock button on the remote control or lock the doors with the key.

(Remember, the system will not ARM if any door, the trunk or hatch is open.)

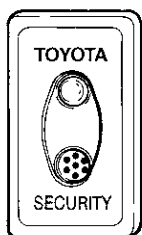

2. Wait until the STATUS MONITOR'S LED starts flashing.

The LED will flash 30 seconds after the last door, the trunk or hatch is closed.

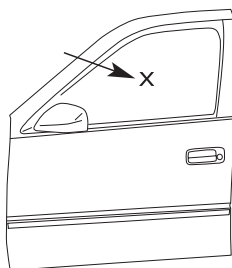

3. With the tip of a key, tap the center of the driver's door window.

Tap the glass with light to moderate force.

WARNING: Do not hit the glass with excessive force, especially in cold weather, or you may crack or break it.

A WARN AWAY ALARM should be TRIGGERED. If the ALARM is not TRIGGERED, make sure you performed the procedure correctly and try again. If you find that the system did not perform as expected, contact your Toyota dealer for more information.

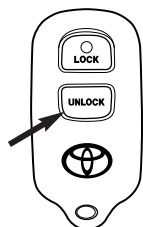

4. DISARM the system to stop the WARN AWAY ALARM.

Press the unlock button on the remote control or use the key to DISARM the system.

PROGRAMMING

The RS3200 PLUS is factory-set to *not* PASSIVELY ARM. To change the system's operation for PASSIVE ARMING operation, as well as adjust the ENTRY DELAY time, follow the procedure below. For more information on this feature, please refer to page 7.

PASSIVE ARMING ON/OFF SELECTION, ENTRY DELAY TIME SELECTION

1. Before you begin:

Close all the doors, and the trunk or hatch.
Unlock all the doors with the inside lock switch.
Remove the key from the ignition switch.

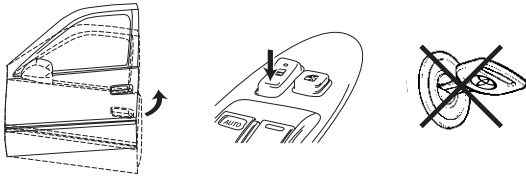

2. Start the Programming Procedure. (Complete these steps within 30 seconds.)

- Using the remote control, **lock**, then **unlock** the doors **3 times**.
- Open** the driver's door.
- Lock**, then **unlock** the driver's door inside lock button **3 times**.
- The system locks the door in 2 seconds; if this does not happen, start over.
- Unlock** the driver's door inside lock button.

3. Select the Operating Mode and Complete the Programming Procedure.

- Close**, then **Open** the door:
2 times = PASSIVE ARMING **OFF**
3 times = PASSIVE ARMING **ON**,
0 Sec. ENTRY DELAY
4 times = PASSIVE ARMING **ON**,
15 Sec. ENTRY DELAY
5 times = PASSIVE ARMING **ON**,
30 Sec. ENTRY DELAY
- Lock** then **unlock** the driver's door inside lock button **1 time**.
- The system unlocks the door in 2 seconds; if this does not happen, start over. Programming is now complete.

PROGRAMMING

IGNITION-CONTROLLED AUTOMATIC DOOR LOCK/UNLOCK (4RUNNER ONLY)

The RS3200 PLUS is factory-set to automatically lock your vehicle's doors when you turn the ignition key to "ON" or "START", and unlock the doors when you turn the key back to "ACC" or "LOCK". To change the programming of this feature, follow the procedure shown below.

1. **Before you begin:**
Open the driver's door.
Remove the key from the ignition switch.

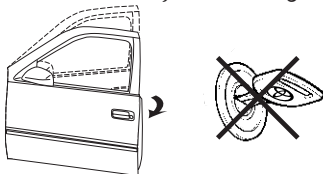

2. **Start the Programming Procedure.**
(Complete these steps within 30 seconds.)

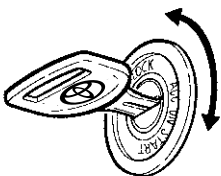

- a. Insert the key into the ignition switch and **turn it from LOCK to ON 5 times** (ending at ON).

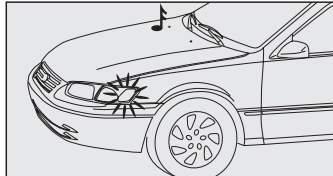

- b. The tail and marker lights **flash once**, and the buzzer **chirps once**.*

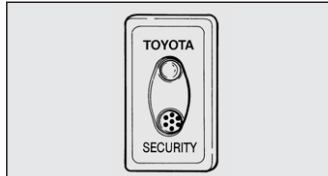

- c. The STATUS MONITOR's LED (or the engine immobilizer system's LED) turns on for 30 seconds.

Note: If the system does not activate the lights and buzzer, start over.

3. **Select the Operating Mode and Complete the Programming Procedure.**

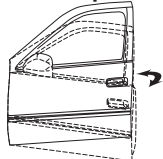

- a. **Close the door = IG. Controlled Door Locks ON**

Close, then **open and close the door again = IG. Controlled Door Locks OFF**

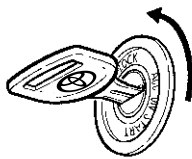

- b. **Turn the ignition key back to lock.**

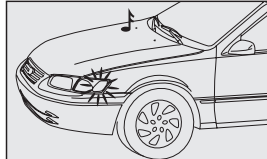

- c. The tail and marker lights **flash once** and the buzzer **chirps once** when the system is set for **IG door lock control ON**, **twice** for **IG door lock control OFF**. If this does not happen, start over. Programming is now complete.

* If your vehicle is equipped with a buzzer.

Warning

- This product is applicable only to vehicles with 12V DC, negative grounding specifications. *Do not use in vehicles with 24V specifications.* Otherwise, damage to the unit or a fire may result.
- Never attempt to disassemble or modify the product. Otherwise, an accident, fire or electric shock may result.
- When replacing fuses, be sure to use fuses with the same specified capacity (amperage.) Otherwise, damage to the unit or vehicle, fire or electric shock may result.
- If an abnormal condition occurs, such as liquids spilling onto the product, or the product emitting smoke or strange odors, stop using it immediately and consult the dealer from whom you purchased the product. Continued use of the product before corrective actions are taken may result in an accident, injury or fire.
- Never pull the plastic bag over your head. Otherwise, a serious injury or death from suffocation may occur.

Caution

- Do not use this product for applications other than in-vehicle use. Otherwise, an electric shock or injury may result.
- Do not allow children to play with the remote controls. Otherwise, the doors may be locked or unlocked, the security system armed or disarmed, or an alarm triggered unintentionally.
- If this product is dropped or its case is damaged, disconnect the power supply lead and contact the dealer from whom you purchased it to obtain service. Otherwise, a fire or electric shock may result.

